



FENCE PERMIT

SITE ADDRESS: _____ Wheeling, IL PERMIT # _____

Property Owner Name: _____ Cell Phone () _____

Property Owner Address: _____ E-Mail _____

Contractor's Company Name: _____

Contractor's address: _____ Phone () _____

Contractor's E-mail address: _____

Submittal Requirements:

- Copy of a signed contract from the contractor.
• Plat of survey with the fence, the location highlighted; indicate the height and material of the fence.
• Signed easement agreement.

Inspection Requirements: A minimum of 24-hour notice is required for inspections—call (847) 459-2620 with your permit number to schedule.

- Posthole inspection. 36" depth is required, 42" depth is recommended.
• Final inspection when the fence is complete. The finished side must face outward from the property to which the fence is constructed.

TYPE OF FENCE:

Chain Link _____ Picket _____ Rail _____ Stockade _____ Solid _____ Board on Board _____ PVC _____

Height of fence from existing grade: feet _____, inches _____

Length of fence to be installed: feet _____, inches _____

Construction Valuation \$ _____

Letter of authorization or permission: If a homeowner's association for your area has additional restrictions on fence design or features, an authorization letter from the association must accompany this permit application.

The undersigned certifies that the statements in this application are correct. The homeowner is responsible for the proper location and height.

Applicant E-mail _____ Applicant Signature _____

USED FENCING MATERIAL IS NOT PERMITTED. NO FENCE SHALL OBSTRUCT THE DRAINAGE SWALE. NO CHANGE TO EXISTING GRADE WILL BE PERMITTED.

NOTE: ALL APPLICANTS ARE REQUIRED TO NOTIFY J.U.L.I.E. (811).

Total Permit Fee \$ _____

Approved _____ Date _____

Ross Klicker-Director CD



UTILITY EASEMENT

I, the property owner at _____,
Wheeling, Illinois, am aware that if a fence is installed over an
existing utility easement, I acknowledge the fact that from time to
time the Village of Wheeling and other authorized utilities may
require access to the easement, and further acknowledge that upon
request of authorized Village agents, access will be permitted for
service work to existing utilities within the easement. I also
acknowledge and hold harmless the Village from any damage done to
the fence during any work within the easement.

Property Owner's Signature

Date

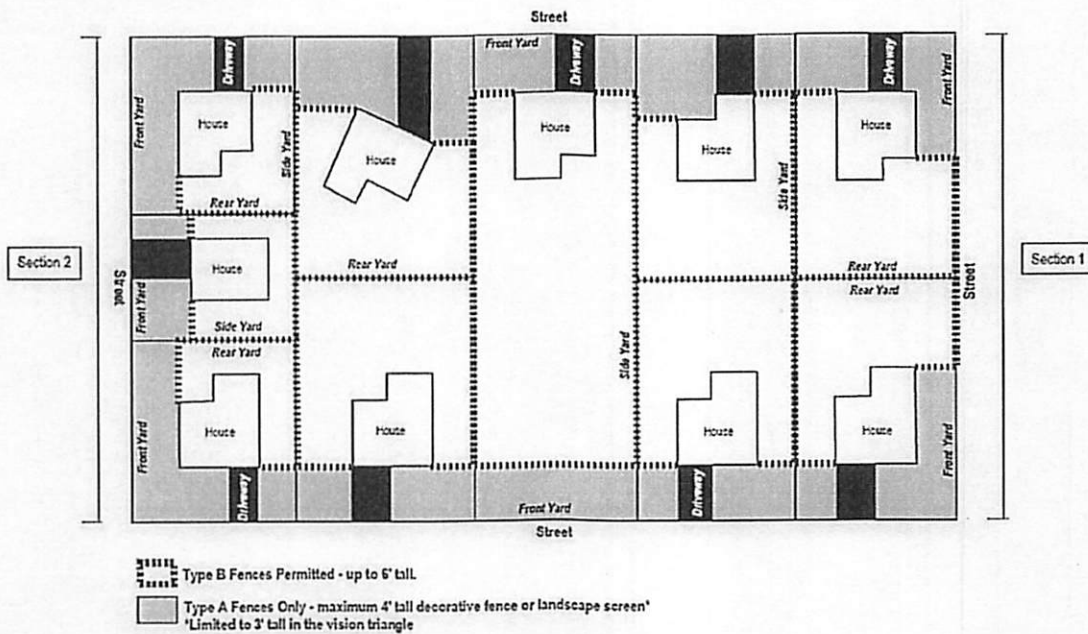
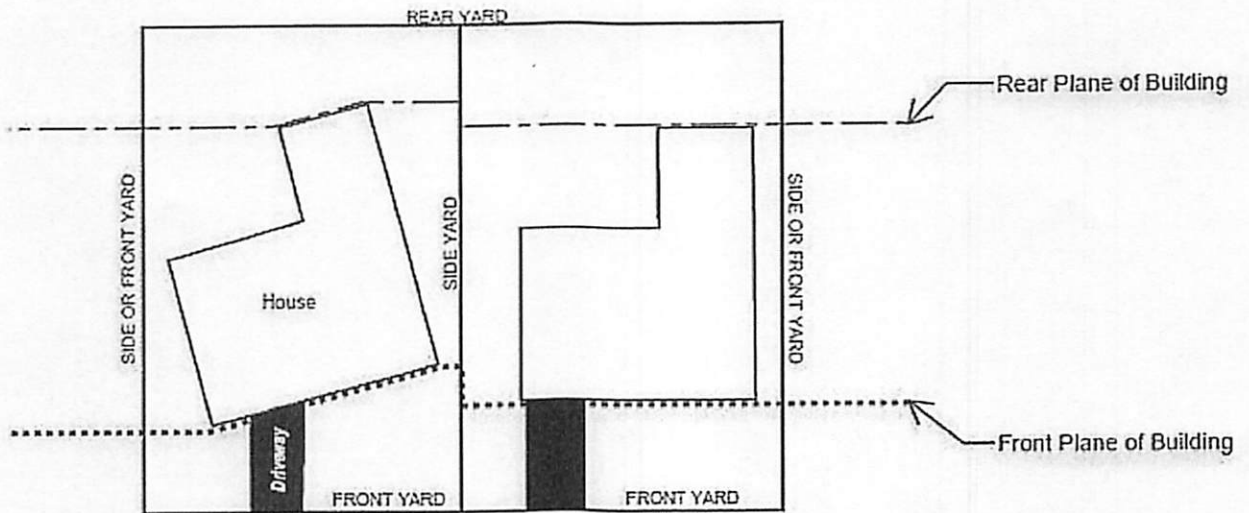

Within the front yard setback area at a height not to exceed four (4) feet above the finished grade level of the ground, provided that it shall be located a minimum of one foot behind the front property line.

Along the side lot lines from a point located one foot behind the front property line extending to the front yard setback line at a height not to exceed four (4) feet above the finished grade level of the ground.

Along the rear property line from side property line to side property line, at a height not to exceed six (6) feet above the finished grade level of the ground.

Along the side lot lines from the front yard setback line to the rear property line at a height not to exceed six (6) feet above the finished grade level of the ground